



Trinity College Dublin
The University of Dublin

Master in Fine Art (Stage Design) Course Handbook

2024-2025

CONTENTS

1 INTRODUCTION	5
1.1 Lir Staff	6
1.2 Administration	7
1.3 Contact Information.....	7
1.4 Student Support and Guidance.....	7
1.5 Postgraduate Advisory Service	7
1.6 Student Resource Room.....	8
1.7 Student Representation.....	8
1.8 Course Materials and Other Costs	9
1.9 Student Learning Development.....	9
1.10 Trinity Disability Service	9
1.11 Student learning difficulties.....	10
1.12 Student Counselling Services	10
2 MASTER IN FINE ART (STAGE DESIGN)	10
2.1 MFA Timetable.....	10
2.2 Term Dates 2024-25	11
2.3 Reading Weeks.....	11
2.4 Major and Minor options.....	11
2.5 Professional Placements.....	12
2.6 Showcase Productions as part of GradFest.....	13
3 THE CURRICULUM	14
3.1 MODULE 1: THEATRE IN CONTEXT	14
3.2 MODULE 2: CONTEMPORARY THEATRE PRACTICE	15
3.2 MODULE 3: COSTUME DESIGN WORKSHOP ¹ _{SEP}	16
3.4 MODULE 4: LIGHTING DESIGN WORKSHOP	17
3.5 MODULE 5: SET DESIGN WORKSHOP	19
3.6 MODULE 6: DRAMATURGY	20
3.7 MODULE 7: PRODUCTION DESIGN	21
4 STRATEGIES FOR MONITORING STUDENT PROGRESS	22
4.1 Student Progress Meetings	22
4.2 Tutorials/Feedback	22
4.3 Student Journals	22

4.4 Oral Examinations	22
4.5 Assessment	22
5 ECTS	22
6 GRADES	23
6.1 Grades and Assessments	23
6.2 Weighting	23
6.3 Overall Assessment and Progression	24
6.4 Awarding of Degrees	24
6.5 Late Submission, Non-submission and Penalties	24
6.6 Extensions and Extenuating Circumstances	25
7 STYLE REQUIREMENTS FOR WRITTEN SUBMISSIONS	25
7.1 Style Requirements	25
7.2 Trinity Policy on Plagiarism	26
8 HOW TO SUBMIT WRITTEN WORK.....	28
9 IMPORTANT SAFETY ISSUES FOR STUDENTS	28
9.1 Security	28
9.2 Fire Safety Procedures	29
9.3 Working with Equipment	29
9.4 Health and Safety	29
9.5 Housekeeping.....	29
10 DATA PROTECTION	30
11 CODES OF PRACTICE	30
11.1 Punctuality and Attendance	30
11.2 Illness or Other Absence	30
11.3 Student Housekeeping	30
11.4 General Upkeep of Rehearsal Rooms, Studios and all Classrooms.....	30
11.5 Personal Property and Storage.....	31
11.6 Lost Property	31
11.7 Food and Drink	32
11.8 Green Room and Café/Front Foyer	32
11.9 Resource Room.....	33
11.10 Wardrobe and Costume Guidelines.....	33
11.11 Props Store Guidelines.....	34
11.12 Professional Courtesy.....	34

11.13 Scripts and Photocopying	34
11.14 Mobile Phones/Social Networking/Recording Devices	34
11.15 Food and Drink	35
11.16 Cloakrooms and Lockers	35
11.17 Press and Publicity	35
11.18 No Smoking Policy.....	35
11.19 Alcohol or Drug Abuse.....	35
11.20 Dignity & Respect	35
11.21 Disruptive or Violent Behaviour.....	36
11.22 Sexual, Gender or Racial Harassment	36
11.23 Gender Equality	36
11.24 Maintaining Good Health	36
11.25 Sustainability and Student Responsibility	37
12 APPENDICES	37
1 Permission to disclose personal information form.....	37
2 Permission to disclose health information form	38
Building Maps	40

1 INTRODUCTION

The Lir Academy is the National Academy of Dramatic Art at Trinity College Dublin. Its aim is to train actors, designers, directors, playwrights, producers, stage managers and theatre technicians to the highest international standards, for careers in the theatre and allied professions. Since opening its doors in 2011 The Lir Academy now delivers seven full-time programmes: the Foundation Diploma in Acting and Theatre, Bachelor in Acting (Hons), Bachelor in Stage Management and Technical Theatre (Hons), MFA Playwriting, MFA Stage Design, MFA Theatre Directing and MFA Theatre Producing. Alongside this, we also offer a host of short courses and other activities and events throughout the year.

The Lir Academy is a creative community bound by a commitment to provide the highest possible conservatoire training in the performing arts in Ireland and is founded on an ethos of equity and humanity. Our teaching is rooted in our close relationship to industry and our desire to support and nurture the next generation of forward-thinking, highly skilled, artistically courageous performers and theatre-makers. The Lir Academy is led by a cohort of experienced theatre industry professionals who take immense pride in teaching their craft.

We believe it is our duty to create graduates attuned to the ever-changing needs of the 21st century's artistic landscape, equipped with the confidence and skill to meet and adapt to those demands. Our principles are founded on a deeply held belief that commitment, talent and passion, combined with our expertise are the keys to unlocking individual artistic excellence for everyone.

In 2024-2025 we welcome a student body of 149 students from all over the world.

This handbook is intended to give the necessary information about the Master in Fine Art (Stage Design). The official regulations for the course are printed in [Trinity's Academic Year Calendar](#) and have primacy over the information in this handbook, which sets out the detailed implementation of those regulations by The Lir Academy.

The information in the introductory section is designed primarily for students new to The Lir Academy. The rest of the handbook gives an account of the requirements for participation in the MFA, so it is essential that students consult it throughout the year. It is each student's responsibility to become familiar with the requirements listed in this handbook.

The Master in Fine Art (Stage Design) runs concurrently with the Master in Fine Art (Theatre Directing), Master in Fine Art (Playwriting) and Master in Fine Art (Theatre Producing). With a view to engendering a sense of ensemble between the students, the programmes are designed to overlap and interact with students on all three strands of the MFA sharing some classes and working together on projects where possible.

1.1 Lir Staff

Director/CEO: Gemma Bodinetz
Academic Director: Professor Brian Singleton (Samuel Beckett Chair of Drama & Theatre)
Director of Administration: Anne Fitzpatrick
Director of Actor Training and Postgraduate Study: Gavin O'Donoghue
Academic Administrator: Colm Carney
Admissions and Short Course Manager: Leonor Madureira
Receptionist: Sarah Kelly
Finance Officer: Sara Scally
Director of Marketing: Jessica Hilliard
Marketing Assistant: Maeve Hickey
Director of Development: Joanne O'Hagan
Course Director Foundation Diploma in Acting & Theatre: David Scott
Commercial Director: Paul O'Connor
Director of Equality & Access: Shaz Oye
Training Coordinator: Katie Sweeney
Director of Technical Training: Eve D'Alton
Production Manager: Des Kenny
Construction Manager and Technical Stage Manager: Jason Coogans
Head of Stage Management: Aisling Mooney
Head of Lighting: Blue Hanley
Head of Costume: Clodagh Deegan
Head of Scenic: Jason McCaffery
Head of Sound: Ivan Birthistle
Events & Operations Manager: Ciara Dredge
Technician & Teacher Support Lighting: Grainne Earley
Technician & Teacher Support Costume: Paul Van Sickle
Head of Short Courses: Roger Evans
Development Officer: Maeve Bradley
Course Director MFA Directing: Annabelle Comyn
Course Director MFA Playwriting: Graham Whybrow
Course Director MFA Stage Design: Maree Kearns
Course Director MFA Theatre Producing: Matthew Smyth

Master in Fine Art (Stage Design) Teaching Staff:

Course Director MFA in Stage Design: Maree Kearns
Theatre in Context & Contemporary Theatre Practice: Thomas Conway
Dramaturgy: Karin McCully
Lighting Workshop: Sinead Wallace
Guest Design Tutors to be announced

Contacting a member of staff:

All staff can be contacted using the following email format:
firstname.lastname@thelie.ie unless otherwise arranged with a member of staff.

We recommend that you email staff to arrange an appointment during their office hours. This is also a useful way of contacting a teacher for a small query if a meeting is not required.

Please do not disturb staff outside their office hours unless you have previously arranged a meeting with them.

1.2 Administration

The administrative office of The Lir Academy is located on the first floor of the building. The Administrator is available to answer questions and provide information every weekday from 9.00am-10.00am and from 12.30pm-2.00pm.

PLEASE NOTE THAT THIS OFFICE IS NOT NORMALLY OPEN FOR STUDENT ENQUIRIES OUTSIDE THESE HOURS WITH THE EXCEPTION OF REPORTING ACCIDENTS AND EMERGENCIES, WHICH SHOULD BE DONE STRAIGHT AWAY

1.3 Contact Information

It is essential that the administrative office has an up-to-date address and phone number for all students. Students should notify the office immediately of any change of contact details. The Administrator and your teachers will often communicate with you via your @tcd.ie email address, so please check your email on a regular basis.

1.4 Student Support and Guidance

Although The Lir's staff are always available to lend a sensitive and supportive ear with regard to any questions, problems, or concerns, there may be some situations for which a student does not feel comfortable approaching these staff members. If necessary, students can consult Professor Brian Singleton, Academic Director of The Lir Academy, who will be able to give confidential advice on matters relating to the course and the workings of the university.

Professor Singleton's contact details are:

Email: bsnglton@tcd.ie

Tel: +353 1 8961550

Trinity's Postgraduate Advisory Service, as outlined below, also provides advice to all postgraduate students.

1.5 Postgraduate Advisory Service

The Postgraduate Advisory Service is a unique and confidential service available to all registered postgraduate students in Trinity College. It offers a comprehensive range of academic, pastoral and professional support dedicated to enhancing your student experience.

The Postgraduate Advisory Service is led by the Postgraduate Support Officer who provides frontline support for all Postgraduate students in Trinity. The Postgraduate Support Officer will act as your first point of contact and a source of support and guidance regardless of what

stage of your Postgrad you're at. In addition, each Faculty has three members of Academic staff appointed as Postgraduate Advisors who you can be referred to by the Postgrad Support Officer for extra assistance if needed.

Contact details of the Postgrad Support Officer and the Advisory Panel are available on our website: http://www.tcd.ie/Senior_Tutor/postgraduate/

The PAS is located on the second floor of House 27. It's open from 8.30am – 4.30pm, Monday to Friday. Appointments are available from 9am to 4pm. Phone: 01 896 1417 Email: pgsupp@tcd.ie

The PAS exists to ensure that all postgrad students have a contact point who they can turn to for support and information on college services and academic issues arising. Representation assistance to postgrad students is offered in the area of discipline and/ or academic appeals arising out of examinations or thesis submissions, supervisory issues, general information on postgrad student life and many others. If in doubt, get in touch! All queries will be treated with confidentiality. For more information on what it offers see the website.

If students have any queries regarding your experiences as a postgraduate student in Trinity, don't hesitate to get in touch.

1.6 Student Resource Room

All students of The Lir Academy will have access to full services of Trinity's library. Additional reference materials and books will be acquired over the course of the year for the Student Resource Room at The Lir. Books must be read in the resource room and should not leave The Lir Academy.

Students may also be required to buy copies of certain texts for classes and/or seminars as they will not be able to depend on the library or resource room for such texts. Further information about reading lists for each class is available from the beginning of each term from individual teachers. Drama and theatre related books are mostly located on the first floor of the Ussher Library, but students will also need to use other parts of the library. The main catalogues are in the Former Berkeley Library, and the Trinity library computer catalogue is available in every library and from the computers in the Student Resource Room at The Lir Academy.

1.7 Student Representation

Each MFA year group elects a student representative, one of whom is entitled to represent the MFA students at meetings of the Master in Fine Art Course Committee. This committee decides on issues such as academic courses, assessment and examining etc., and meets once per year.

Each year group representative will have the opportunity to raise concerns or issues of the course at the committee meeting.

1.8 Course Materials and Other Costs

Although some texts, notes and handouts will be provided by The Lir Academy, and much of the prescribed reading is available from Trinity's library, we advise students to allocate themselves a yearly script budget in order to buy scripts to build up their own Library for professional work. Many of the prescribed plays for the Dramaturgy module are bought in bulk and available from the Academic Administrator at a discounted rate.

Students should also familiarise themselves with the Drama Online database (www.dramaonlinelibrary.com) which is accessible by all Trinity students. Students should access this online library through Trinity library's online portal.

As part fulfilment of the Theatre in Context & Contemporary Theatre Practice module, students are expected to attend up to six nominated theatre performances per term. Student discounts are usually available when booking, however, students should budget up to €300 over the course of the year to cover the cost of these tickets.

Set Design Students are advised to budget up to €300 per year for necessary materials including card and foam board and other materials. Some materials will be bought in bulk and made available to students at a discounted rate.

Costume Design Students are advised to budget up to €300 per year to purchase fabric, costume 'buys' and other materials. Calico and pattern paper are bought in bulk and made available to students at a discounted rate.

Lighting Design Students should budget a minimum €200 for materials including colours and other consumables.

1.9 Student Learning Development

Student Learning Development are here to help you achieve your academic potential while studying at Trinity. They provide workshops and events on a range of academic skills throughout the year, e.g. self-management skills, study and exam skills, presentations, writing and critical thinking. In addition, they also see students on a one-to-one basis for more specific queries by appointment or at our drop-in clinics.

Further information about the services available can be found at <http://student-learning.tcd.ie/>

1.10 Trinity Disability Service

Trinity Disability Service's mission is to create an accessible, transformational, educational environment in an interdependent University community and provide a platform for innovation and inclusion. Lir students may avail of their specialist support and advice at all stages of training. Students with a diagnosis of a physical, mental or intellectual disability may register with the service to receive an individualised Learning Educational Needs Summary (LENS) report. With your permission, this report can be shared with Lir teaching faculty to best support you during your time here.

Students without a diagnosis may still contact the Disability Service for advice, guidance and support on challenges they may be experiencing during their studies. For further information, and to book an appointment, students are encouraged to review the Disability Service website at www.tcd.ie/disability.

1.11 Student learning difficulties

Students with learning difficulties are encouraged to register with Trinity Disability Service. Specialist support is available for conditions such as dyslexia, dyspraxia, ADD/ADHD, OCD and autism diagnoses.

Assistive Technology is available for students throughout their time at The Lir Academy. Examples include Notetaking Tools, Speech to Text Conversion Tools and Reading and Writing support. Students can find more information at <https://www.tcd.ie/disability/services/assistive-tech/>.

1.12 Student Counselling Services

- Confidential help with personal problems is available for all students through Trinity's Student Counselling Services which are located at 9 South Leinster Street - just a 15 minute walk from The Lir's campus.
- For the 2024/2025 academic year, one-on-one appointments will also be available in the main Lir building on Tuesday and Wednesday evenings.
- Appointments may be made by contacting their office via telephone on 01 896 1407 or by emailing student-counselling@tcd.ie.
- Further information about the services available can be found at www.tcd.ie/Student_Counselling/

2 MASTER IN FINE ART (STAGE DESIGN)

The Master in Fine Art (Stage Design) is a vocational degree. It requires enormous personal commitment and dedication. Great emphasis is placed on group learning and shared endeavour. The course also requires sustained effort and individual responsibility for development in all subject areas.

2.1 MFA Timetable

The one-year, full-time Master in Fine Art (Stage Design) Degree is taught over three terms. Students taking the course part-time will complete the programme over two years. The first two terms are of twelve weeks' duration, when full-time students will take four modules.

Part-time students will ordinarily take three modules (one minor) in the first two terms of year one, and their major module in the first two terms of their second year. The final module will be taught in the third semester and subsequent summer months (for full-time students) or in the second year of the course (for part-time students). The final module will be taught by an on-going series of individual tutorials.

Classes in the first two terms will normally take place between 9.30am and 5.30pm on weekdays, but may need to be rescheduled, including at evenings and weekends, in exceptional circumstances. Students are expected to prioritise classes and make

themselves available at the rescheduled time. In addition, a number of skills classes will be scheduled throughout Terms One and Two at times to be confirmed in advance. Other responsibilities, including self-directed learning, will be scheduled in the evenings and exceptionally on weekends.

MFA students will be expected to attend selected theatre performances and screenings, usually on Wednesday evenings, throughout and will be encouraged to participate in shared activities with the Bachelor in Acting (Hons) programme.

Students will receive a copy of the timetable at the beginning of each term for weeks 1-6 and at half-term for weeks 8-12. All timetables are subject to change and students are expected to check the MFA notice board on a regular basis for any timetabling announcements.

2.2 Term Dates 2024-25

The Term Dates for 2024-25 are as follows:

- Term 1: Monday, September 16th – Friday, December 6th 2024
- Term 2: Monday, January 8th – Friday, March 28th 2025
- Term 3: Tuesday, April 22nd – Friday, July 11th 2025

The Term Breaks are:

- Saturday, December 7th to Sunday, Jan 5th 2025
- Saturday, March 29th to Monday, April 21st 2025

The MFA (Stage Design) course is a 12-month year-long programme. Students should note however that, as outlined below, some placement opportunities may run slightly over this timeline. If this poses particular problems for individual students, they should make their course director aware of the situation as early as possible so that it can be factored into the planning of individual placements.

2.3 Reading Weeks

The seventh week of each term is designated as Reading Week. During Reading Weeks, timetabled classes, workshops and seminars pause. This is to allow students time to complete the required reading for each class. Furthermore, it is likely during each term that a week's classes will be replaced by individual tutorials with MFA teachers. The timing of individual tutorials will be at the discretion of each teacher and will be communicated at the beginning of each term.

2.4 Major and Minor options

All design students 'major' in one design discipline. Students can also elect to take a second design discipline as a 'minor' option.

Students minoring in a discipline will:

- Complete all workshop projects and skills classes attached to the design module in Terms One and Two.

Students majoring in a discipline will:

- Complete all workshop projects and skills classes attached to their design module in Terms One and Two.
- Complete two placements in their major discipline
- Produce a production design for one of the MFA Graduate Productions in their major discipline.
- At the discretion of the Course Director and Director of Actor Training and Postgraduate Study, be invited to exhibit a selection of work either in a digital or physical exhibition as part of the Production Design module (Gradfest).

Additional opportunities for minor students:

Should the opportunity present itself, students minoring in a design discipline who have excelled in their project work throughout Terms One and Two may be invited to produce a production design for one of the MFA Graduate Productions in their minor discipline. This work will not form part of the formal course assessment and students may decline the opportunity at their discretion.

At the discretion of the Course Director, students who produce work of a sufficient standard in their minor discipline may also be invited to present work in the MFA design exhibition.

2.5 Professional Placements

All Stage Design students will complete two professional placements as part-fulfilment of Module 7: Production Design as outlined below.

One of these placements will involve assisting a professional designer on the realisation of their designs on one of The Lir's Graduate Productions. This placement may occur in either Term 3 of the 2024/25 academic year or Term 1 of the 2025/26 academic year.

Students majoring in lighting design may also be offered the opportunity to complete their internal placement on graduate productions at the end of Term Two.

The second placement will involve assisting a professional designer on the realisation of their designs on a professional production in Dublin. The dates for this placement will be agreed in consultation with the student as the production schedules of the hosting theatres are confirmed. Some of these placements are likely to be on Dublin Theatre Festival productions which may open as late as the end of September or the first week in October 2024. Students should bear this in mind when budgeting for the year.

Given the nature of a designer's work, students will not be expected to work full-time when on placement but are expected to be available for key moments in the realisation of the design concept, for significant design and production meetings, for the technical build and rehearsals, throughout previews and to be available at all other times to assist the professional designer as required.

Given the nature of this commitment, it may be possible for the dates of these placements to overlap somewhat, although the placement will not overlap at key dates in each production's technical schedule.

Students will be supported by ongoing contact with their design tutors throughout both placements.

Placements will be assessed on the basis of a critical reflection to be completed by the student and by a formal review between the professional designer and the design tutor.

2.6 Showcase Productions as part of GradFest

From the beginning of Term Three, MFA (Stage Design) students will focus on placements and the Production Design module. Full-time students will work towards a production showcase in July 2025. Part-time students will present their work to the public in July 2026.

Students will work with the Lir's graduating acting students and colleagues from the MFA in Theatre Directing on a series of productions to be staged in the Lir's two performance studios at the end of the academic year as part of a season of work entitled GradFest. The productions will be fully supported by the Stage Management and Technical Theatre students and the technical and workshop staff of The Lir Academy. The design students will also be supported throughout this process by their design tutor. Full details of the production process will follow in Week Six of Term One.

Showcase productions will be assessed by the Course Director and the Director of Actor Training & Postgraduate Study and Academic Director of The Lir Academy (or their agreed deputies) as outlined in Section 3.5 below, and the assessment process will be overseen by an External Examiner.

Outline Production dates:

23/06/25	Week 10	Gradfest Week 1
30/06/25	Week 11	Gradfest Week 2
07/07/25	Week 12	Gradfest Week 3

A note on copyright: Design students should note that although they will retain the copyright in all their design work throughout their MFA programme, The Lir Academy retains a perpetual right to photograph and record the production for publicity purposes to promote the production, the student's work, The Lir's courses including the MFA Stage Design and The Lir Academy generally.

3 THE CURRICULUM

The design strand of the MFA aims to equip students of exceptional talent with the skills necessary to pursue a career in the professional theatre and related industries through the development of skills, professional practices and creative approaches to stage design.

It encourages a self-reflexive approach to learning with a view to developing independently-thinking practitioners of theatre. The individual voice of the student designer will be nurtured and developed through a series of practical design workshops and tutorials with professional designers, directors and dramaturges. A series of skills classes in each discipline will complement the project-based workshops. Classes in dramaturgy and contemporary theatre practice will supplement the training and placements alongside two professional theatre designers will form a key component of the programme. The course will culminate in the design of a production that will benefit from one-on-one mentoring by a professional designer.

In addition to the core classes and workshops, individual tuition from professional designers will be a key feature of the training. Masterclasses by visiting practitioners will supplement the student experience.

Students must take five modules to complete the course. Modules 1, 2 and 6 are compulsory modules and students must choose two elective modules from Modules 3, 4, & 5.

The course is designed to allow students to study one or two design disciplines. Where a student elects to study two design disciplines they will elect to 'major' in one discipline and 'minor' in the second. Students 'majoring' in a specific discipline will complete their professional placements in that discipline and will focus on that discipline in the Production Design module. Students elect to take this course either part-time (24 months) or full-time (12 months).

3.1 MODULE 1: THEATRE IN CONTEXT

Module Code:

Module Coordinator: Thomas Conway

Teaching staff: Thomas Conway

Term: 1

Average Teaching Hours: 3 hours per week

Aims:

The aim of this compulsory module is to deepen students' engagement with, and understanding of, contemporary theatre as presented in the leading venues and festivals in Dublin. In doing so, students will also expand their knowledge of 21st century theatre practice and bring an informed, critical lens to their theatre-going. Students will also gain a critical overview of the practical and artistic challenges that they will meet over the span of their own careers as future artists and leaders. By taking this module with practitioners from all MFA strands, students will broaden their own understanding of each other's practice and acquire a shared language for engaging with, critiquing and conceiving theatrical works of ambition. The module will also have a specific focus on professional development, which will be enhanced by the students' encounters with guest artists and industry leaders.

Learning outcomes:

On successful completion of the module students should be able to:

- Critique contemporary theatre, dance and live art practices
- Apply a historical frame of reference to their analysis of the live performance
- Reflect critically on the work and careers of leading artists, practitioners and stakeholders
- Describe the working practices of theatre practitioners across all disciplines
- Design strategies to advance their own future careers and professional development

Working method:

This module will be taught over Michaelmas term. The module is shared across all MFA strands, including theatre directors, designers and playwrights. Students will attend five live theatre productions together over the course of term and attend a weekly three-hour-long seminar. Part of each seminar will comprise a meeting with the artists, curators and practitioners who led on the creation of the live performances attended by the students. Leading arts leaders, directors, funders and stakeholders will also be invited as guest speakers at the seminars.

Assessment:

- Portfolio of Reflective Journal entries, weighting 50%
- Written critical assessment, weighting 25%
- Written critical assessment, weighting 25%

Reading List:

Students will be assigned reading and recordings relevant to the productions scheduled in the theatre, including play texts, journal articles, newspapers and periodicals.

3.2 MODULE 2: CONTEMPORARY THEATRE PRACTICE

Module Code:

Module Coordinator: Gavin O'Donoghue

Teaching staff: Thomas Conway

Term: 2

Average Teaching Hours: 3 hours per week

Aims:

The aim of this compulsory module is to enable students to become familiar with the practices, processes, and critical frameworks in the production and reception of contemporary theatre. Students will encounter the principal forms of contemporary practice, including theatre adaptations, documentary theatre, post-dramatic theatre, dance theatre, live art, participatory practice and developments in contemporary playwriting. Students will learn to critique the aesthetic, ethical and political dimensions to contemporary theatre, particularly as they relate to such issues as gender identities, racial and ethnic identity, sexual identity, perceptions around disability and sustainability. Students will gauge their own artistic practice against the various production methods, rehearsal processes, and framing strategies of established contemporary theatre artists.

Learning outcomes:

On successful completion of the module students should be able to:

- Analyse a broad spectrum of contemporary theatre, contemporary dance and live art practices
- Identify and interface with the working methods of a range of international theatre practitioners
- Critique the technical, strategic, aesthetic, ethical and political responses of leading theatre professionals to contemporary issues
- Review the various methods for framing a diversity of experiences for contemporary theatre audiences
- Assess their own creative concerns and practices against the work of leading international artists

Working method:

This module will be taught over Term 2 in a series of weekly seminars. The module is taken by MFA students from all disciplines including playwrights, designers, directors, and producers. In advance of each seminar, students will read play texts and critical and view recordings of seminal 20th and 21st century productions. Students will research leading international theatre artists and contextualise their productions with reference to theatre history.

Assessment:

- Seminar Presentation, weighting 10%
- Seminar Presentation, weighting 10%
- Seminar Presentation, weighting 10%
- Seminar Presentation, weighting 10%
- Seminar Presentation, weighting 10%
- Two written critical assessments, weighting 50%

Reading List:

Students will be assigned reading and recordings relevant to the productions scheduled in the theatre, including play texts, journal articles, newspapers and periodicals.

3.2 MODULE 3: COSTUME DESIGN WORKSHOP

Module Code: LR7005

Module Coordinator: Gavin O'Donoghue and Maree Kearns

Teaching staff: Joan O'Clery, Sinead Lawlor, Arran Murphy, Clodagh Deegan, Catherine Fay
Term: 1 and 2
Average Teaching Hours: 3-6 hours per week.

Aims:

This elective module will be taught over two terms in a series of workshops by a number of professional designers. It aims to nurture the student's design skills through workshops aimed at developing the student's creative practice. Those workshops will introduce students to the processes of historical research as well as the technical skills in the realisation of a design, including wardrobe maintenance, and communication with other theatre professionals in the production process. Students will present their own practice in weekly workshops for discussion and critique. In addition, students will maintain a weekly journal of reflective practice in which they will analyse their process.

Learning outcomes:

On successful completion of this module students should be able to:

- Communicate design ideas to a director and to other members of a creative team. Produce costume designs appropriate for the text.
- Liaise with a production manager and costume maker on the implementation of a design from a technical perspective.
- Respond to and process criticism positively.
- Incorporate research in the design process.

Working Methods:

This module will be taught over Terms One and Two in a series of workshops led by professional designers. It aims to develop the student's costume design skills through weekly workshops exploring a range of dramatic texts from various historical periods, as well as nurturing technical competence in the realisation of the student's own design. In addition, students will maintain a weekly journal of reflective practice in which they will analyse their process.

The workshop will be supplemented by a series of skills-based classes including drawing, practical costume skills, costume construction, scenic art and the history of scenography.

Assessment:

- Design Project 1 (Term One) (15%)
- Design Project 2 (Terms One and Two) (15%)
- Design Project 3 (Term Two) (20%),
- Design Project Four (Term Two) (20%)
- General Presentation (portfolios, notebooks, communication skills, etc) (20%)
- Continuous Assessment including engagement and attendance (10%)

3.4 MODULE 4: LIGHTING DESIGN WORKSHOP

Module Code: LR7006

Module Coordinator: Gavin O'Donoghue and Sinéad Wallace

Teaching staff: Sinéad Wallace, Kevin Smith, Israel del Barco

Term: 1 and 2

Average Teaching Hours: 6 hours per week.

Aims:

This elective module will be taught over two terms in a series of workshops led by a number of professional lighting designers. It aims to nurture the student's design skills through workshops aimed at developing the student's creative practice. Those workshops will examine the nature of light and its qualities, together with the functions of stage lighting, the role of lighting in theatre, with particular emphasis on the engagement of a director with stage lighting. Students will explore the relationship between lighting design and other design elements, e.g. costume design, set design, sound and video design. In addition to the development of a conceptual lighting design process, the mechanics of stage lighting will be covered in detail to include the principles of electricity, optics, light sources and theatre lanterns. Students will learn how to choose lighting instruments, calculate lighting angles, control light distribution etc., and will learn the basic principles of scale drawing, and how to produce a lighting plan. Other topics covered will include control systems, computer aided design, colour and collaborative skills. Students will maintain a journal for each individual project as well as a photo journal in Term 1.

Learning outcomes:

On successful completion of this module students should be able to:

- Realise a lighting design for the theatre using a range of technical equipment.
- Realise a design through a scale drawing and Vectorworks.
- Respond to and process criticism positively.
- Incorporate research in the design process.

Working Methods:

This module will be taught over Terms One and Two in a series of workshops led by professional lighting designers. It aims to develop the student's lighting design skills through weekly workshops exploring a range of dramatic texts, as well as nurturing technical competence in the realisation of the student's own design. In addition, students will maintain a weekly journal of reflective practice in which they will analyse their process and collect a library of reference images relevant to their own projects and observation of light in the world. The workshop will be supplemented by a series of skills-based classes including CAD (Vectorworks), ETC lighting consoles and the history of scenography. The learning will also be supplemented by a series of masterclasses including the use of video with light and new technologies in lighting design.

Assessment:

Three lighting design projects (computer-aided and scale drawing) - one in Term One and two in Term 2.

Weighted as follows:

- Project 1 (15%)
- Project 2 (20%)
- Project 3 (25%)
- Continuous assessment (communication, workshop projects, learning) (15%)

- Critical thinking project & photo journal with reflections in Term 1 (15%)
- Engagement (attendance, punctuality, commitment, collegiality) (10%)

3.5 MODULE 5: SET DESIGN WORKSHOP

Module Code: LR7007

Module Coordinator: Gavin O'Donoghue and Maree Kearns

Teaching staff: Maree Kearns, Owen Boss, John Comiskey, Alyson Cummins, Ciara Murnane, Conor Hanratty and others.

Term: 1 and 2

Average Teaching Hours: 3-6 hours per week.

Aims:

This module will be taught over two terms in a series of workshops by a number of professional designers. It aims to nurture the student's design skills through workshops aimed at developing the student's creative practice. Those workshops will introduce students to the processes of historical research as well as the technical skills in the realisation of a design, including drawing, model-making, technical drawing, and communication with other theatre professionals in the production process. Students will present their own practice in weekly workshops for discussion and critique. In addition, students will maintain a weekly journal of reflective practice in which they will analyse their process.

Learning outcomes:

On successful completion of this module students should be able to:

- Communicate design concepts to a director and to other members of a creative team
- Produce scenic models of their designs
- Produce thorough technical drawings for a theatre design
- Respond to and process criticism constructively
- Incorporate research in the design process
- Understand how to budget a design for a show and modify a design in response to financial or practical constraints

Working Methods:

This module will be taught over Terms One and Two in a series of workshops led by a number of professional designers. It aims to develop the student's set design skills through weekly workshops exploring a range of dramatic texts, as well as nurturing technical competence in the realisation of the student's own design. In addition students will maintain a weekly journal of reflective practice in which they will analyse their process. The workshop will be supplemented by a series of skills-based classes including drawing, model making, the history of scenography, scenic art, manual draughting and CAD.

Assessment:

- Design Project 1 (Term One) (15%)
- Design Project 2 (Term One) (15%)
- Design Project 3 (Term Two) (20%)
- Design Project Four (Term Two) (20%)
- General Presentation (portfolios, notebooks, communication skills, etc) (20%)

- Continuous Assessment including engagement and attendance (10%)

3.6 MODULE 6: DRAMATURGY

Module Code: LR7010

Module Coordinator: Gavin O'Donoghue

Teaching staff: Karin McCully

Term: 1 and 2

Average Teaching Hours: 3 hours per week

Aims:

This module will be taught over two terms (Terms One and Two) by a professional dramaturg. It aims to introduce students to a range of dramatic texts with an emphasis on their composition. An understanding of the contexts within which different dramaturgical strategies were produced will also be fostered. This seminar-based module requires students to examine key issues related to the creation and structure of plays. Through close readings, students will consider a variety of theories regarding dramatic structure, style, and form, explore different approaches to textual analysis and learn to apply a critical vocabulary to a number of case studies. Dramaturgy is a compulsory module for producing, playwriting and directing students and an elective module for design students.

Learning outcomes:

On successful completion of this module students will be able to:

- Demonstrate knowledge of a range of dramatic texts from known theatre history; compare and contrast those texts with experimental and contemporary texts.
- Demonstrate knowledge on theory and practice that challenges the mainstream canon.
- Have gained confidence in the ability to interrogate the canon from a contemporary viewpoint.
- Undertake research from a dramaturgical perspective.
- Analyse texts from a dramaturgical perspective.
- Demonstrate knowledge of the relationship between text and performance.
- Reflect on one's own creative process from a dramaturgical perspective.
- Demonstrate a solid overview of Western theatre history to provide a context for their own development as a theatre practitioner.

Working method:

Classes will be in the form of weekly three-hour seminars shared with the directors, playwrights, producers and those designers who elect to take the module.

Students will be asked to make brief presentations to the class on chosen plays' style, context, structure, ideas, and themes, and to put questions to the seminar to lead the debate on their assigned text. The plays assigned each week are then compared considering the seminar's accumulative discoveries.

Assessment:

- A series of assignments as follows:
- Term One Essay (2000 words) (30%)
- Term Two Production Dramaturgy presentation (2000 words) (30%)

- Class Presentations including submission of two written-up presentations (2000-3000 words approximately) (25%)
- Continuous assessment (15%)

3.7 MODULE 7: PRODUCTION DESIGN

Module Code: LR7009

Module Coordinator: Gavin O'Donoghue, Maree Kearns & Sinéad Wallace

Teaching staff: Maree Kearns & Sinéad Wallace

Term: 3 (full-time); 3-6 (part-time)

Average Teaching Hours: Individual tuition on an on-going basis in response to work completed and two part-time, six-week placements.

Aims:

The aim of this compulsory module is to enable students to apply the skills acquired in their elective design modules to the development of their individual creative voice and practice, and in the design of one of the final MFA productions. Students will also extend their understanding of theatre production by completing two placements assisting professional theatre designers on productions. A further focus on professional development will assist the students to prepare for a professional career.

Learning outcomes:

On successful completion of this module students should be able to:

- Undertake research from a design perspective
- Realise a design for a theatre production
- Reflect on the creative process of theatre production
- Respond to and process criticism constructively
- Communicate effectively with other theatre professionals (director, production manager, stage manager and a technical team)
- Manage a design schedule and budget
- Be actively involved in the fit up and technical rehearsals for a theatre production

Working Methods:

This module will be taught in Term Three and over the summer months through individual supervision on the realisation of a design for public viewing in one of The Lir's studios in addition to two placements as an assistant to a professional designer. Students are required to maintain a reflective journal which may form part of their assessment as below. A series of professional development talks, seminars and classes will complete the module.

Assessment:

Students majoring in Set & Costume Design

- Design & realisation for a theatre production (60%)
- Process and reflective journal (40%)

Students majoring in Lighting Design

- Design for a theatre production (70%)
- Process and Reflective Journal (30%)

4 STRATEGIES FOR MONITORING STUDENT PROGRESS

4.1 Student Progress Meetings

Student Progress Meetings take place at least once per term when the teaching team meet collectively to discuss an overview of each student's development. Student Overview Meetings are monitored primarily by Director of The Lir Academy. Teachers on the MFA course also meet regularly to consider matters of student progress.

4.2 Tutorials/Feedback

Tutorials are designed to afford each student the opportunity to discuss their progress and receive guidance. Feedback is offered by teachers and staff on specific areas of work. Students receive tutorials from teachers and staff at strategic points in the year.

4.3 Student Journals

Students are encouraged to maintain a journal of their time on the course. This is an opportunity for reflection on daily and weekly work in classes and seminars, and is meant to be a personal record of the student's learning experience. Journals may form part of the assessment of a student's grade.

4.4 Oral Examinations

If deemed necessary or appropriate, oral examinations consist of two prepared topics based on the curriculum. Students are then interviewed on their chosen topics for 20 minutes by two members of the Course Committee.

4.5 Assessment

Assessment is the process by which formal judgments are made on standards of work. At The Lir Academy, it is also used as a strong aid to guiding students on their progress. Information on how each class is assessed is included in the curriculum above.

5 ECTS

All university course modules in the European Union have an ECTS value. ECTS stands for European Credit Transfer System. The credit value is based on the number of weeks of each module, and the number of hours of scheduled taught classes and expected student input for assignments. The ECTS value for the modules of the degree are as follows:

Core Module: Theatre in Context (10 ECTS)
Core Module: Contemporary Theatre Practice (10 ECTS)
Elective Module: Dramaturgy for Stage Design (20 ECTS)
Elective Module: Costume Design Workshop (20 ECTS)
Elective Module: Lighting Design Workshop (20 ECTS)
Elective Module: Set Design Workshop (20 ECTS)
Core Module: Production Design (30 ECTS)
TOTAL (with two elective modules): 90 ECTS

6 GRADES

6.1 Grades and Assessments

Although final degrees will not be graded, student's assessments will be marked to give them an indication of their progress.

Grade descriptors for Module 1 - 6 of the MFA Stage Design strand are as follows:

85-100: Work of exceptional merit, demonstrating an original creative vision, fluency of expression and breadth of reference far in excess of what is expected for a one-year higher research degree.

75-85: Work of outstanding merit which shows insight, profundity, and creative invention, characterised by involvement with subject matter, breadth of appropriate reference, and both conceptual and stylistic ability. In oral presentation, a combination of the above with a finely judged ability to structure material and communicate it in an oral context.

70-74: Work of similar standard to the above category but not to the same degree or level of consistency.

60-69: Very good work characterised by coherence and relevance, soundness of argument, appropriateness of reference, depth of background knowledge and discrimination. Some qualities of first-class work may be in evidence but the difference will be in degree of realisation.

50-59: Consistently solid work reflecting honest application and satisfactory achievement without ever fully attaining the creative invention associated with the higher grades. The work may be characterised by an over-reliance on secondary sources at the expense of personal involvement, confining itself to a limited or predictable line of argument with a tendency to description. It may contain sophisticated elements but be unable to integrate these into a complex but coherent argument. On the other hand, it may be characterised by a lack of full engagement with the material, a lack of breadth of critical reference or of sufficient theoretical thrust.

Pass Mark: 50

40-49: Work which demonstrates some background knowledge and research but no consistent or rigorous investigation; argument remains at a basic level, without sufficient analysis to achieve insight or coherence; repetitiveness, excessive reliance on secondary sources, imprecise expression or descriptive generalisation. Work of this grade is not considered sufficient for a postgraduate degree.

1-39: Failure to demonstrate most of the standards set out above.

Grade descriptors for Module 7 (Production Design) are as follows:

- **70% or above:** imaginative practice achieving an exceptional level of creativity to a professional standard.
- **60% or above:** creative practice with an achievement that demonstrates a very good level of understanding of the requirements of stage design. Students at the higher end of this marking band may display elements of the requirements of the higher band but not to the same level or degree of professional achievement.
- **50% or above:** creative practice with an achievement that demonstrates a satisfactory understanding of the mechanics of stage design but to a level that could not be considered adequate for professional production.
- **49% or below (FAIL):** a level of achievement that fails to demonstrate a satisfactory understanding of the mechanics of stage design.

6.2 Weighting

Assessments for the Compulsory Modules 1 and 2 are weighted equally at 10% each (20% total), 2 elective modules at 20% each and the Production Design (Module 7) is weighted at 40%.

6.3 Overall Assessment and Progression

The pass mark for all assignments, including the Theatre Production module, is 50%.

Students must achieve an overall credit-weighted average mark of 50% or higher across the taught modules, and must pass all individual taught modules, in order to proceed to the Theatre Production module.

Students who fail a taught module and who are not eligible to proceed to the Theatre Production module are entitled to re-submit failed assignments in the module to be considered for the award of Postgraduate Diploma in the appropriate strand. Re-submission of failed assignments for the award of Postgraduate Diploma is normally due on August 31st or if this falls on a weekend, the Friday before. A supplemental assignment can only be awarded a maximum mark of 50%.

6.4 Awarding of Degrees

Students who have successfully passed the four taught modules and accumulated 60 credits but do not wish to proceed to the Theatre Production module, or if they have attempted but failed this module, will be eligible for a Postgraduate Diploma. Students who, in addition, have achieved an overall average mark of at least 70% across the three taught modules will be eligible for the award of Postgraduate Diploma with Distinction. A Distinction cannot be awarded if a candidate has failed any assignment during the period of study.

Students who have achieved a mark of at least 50% in each module taken and accumulated 90 credits will be eligible for the award of Master in Fine Arts.

Students who, in addition, achieve a mark of 70% or above in the Theatre Production module and have an overall average mark for the course of at least 70% will be awarded the M.F.A. with Distinction. The Master in Fine Arts cannot be awarded with Distinction if a candidate has failed any assignment during the period of study.

6.5 Late Submission, Non-submission and Penalties

It is expected that assignments and set work will be submitted in full and on time. Submission dates will be communicated to students with sufficient notice to allow for arrangements to be made to ensure the submission deadline can be met. Written assignments must be submitted through [TurnItIn.com](https://turnitin.com) which will assess for plagiarism. Full submission details will be communicated to you via the administration office early in Term 1. The online submission deadline will ordinarily be 12 noon on the date of submission, unless otherwise communicated. In the event of late submissions, the following penalties will apply:

- Submissions received up to one week late (7 days) will receive a penalty of 10%
- Submissions received up to two weeks late (14 days) will receive a penalty of 20%
- Submissions received after two weeks, or not received after this time, will receive a grade of zero and be recorded as a fail

Students who fail or fail to submit a particular assignment will be offered one (1) supplemental (re-sit) assignment, which will be assigned by the module leader. Grades for supplemental assignments will be capped at 50%.

6.6 Extensions and Extenuating Circumstances

Extensions may be requested in writing in advance directly to the administration office. They should include relevant supporting documentation e.g. medical certification, as necessary. The maximum extension that can be granted is one day (24 hours). Similarly, a student may apply directly to the administration office in writing for consideration of extenuating circumstances in the event that they miss a deadline due to unforeseen circumstances. These should also include relevant supporting documentation. Such applications may be considered by one or all of the Course Leader, Director of Actor Training & Postgraduate Study and Academic Director as necessary and will not be decided by the module leader. Applications for extenuating circumstances will be considered sympathetically and treated with the strictest confidence.

7 STYLE REQUIREMENTS FOR WRITTEN SUBMISSIONS

7.1 Style Requirements

Please consult the MLA or Chicago academic writing style requirements.

Full access to the Chicago Manual of Style online is available via the TCD Library website. Alternatively, please see below.

Chicago Manual of Style, 15th edition, Chicago: Chicago University Press, 2003. You may also consult the Chicago style requirements at:

http://www.chicagomanualofstyle.org/tools_citationguide.html

For details of the MLA please see:

Gibaldi, Joseph, *MLA Style Manual and Guide to Scholarly Publishing*, 2d Edition, New York, MLA, 1998.

You may also consult the MLA style requirements at:

<http://owl.english.purdue.edu/owl/resource/557/01/>

Please remember to always quote accurately, to be consistent in your style and referencing and pay attention to detail. Proofread your essays carefully before submitting them in order to eliminate spelling and typing errors, misquotation and unsatisfactory presentation.

Please note that all coursework elements have deadlines. If you wish to apply for an extension you must consult with the relevant teacher and if an extension is agreed, then please ensure that all supporting documentation is attached to your final submission.

Acknowledgements and Footnotes:

(1) Students should always acknowledge their sources:

Students should remember that plagiarism is a serious offence and will result in disciplinary procedures.

Plagiarism is:

- The presentation of another person's thoughts or words as though they were a student's own.
- Direct quotations from the published or unpublished work of others must always be clearly identified by being placed in quotation marks, and a full reference to the source must be provided in the manner outlined below.
- Equally, if a student summarises another person's ideas or judgements, they must refer to that person in their text, and include the work referred to in their notes and bibliography.
- Any instance of plagiarism within an essay, examination or dissertation will render the work invalid for examination and assessment purposes and it will be reported to the Junior Dean of the College.

If a whole section of a student's work is based on data provided by a single source, they should make a general acknowledgement in the text of their essay, as follows:

'This section on directing *The Life of Galileo* is based on the account of the National Theatre production in Jim Hiley, Theatre at Work, London, 1981.'

Note, however, that such a blanket statement does not give the student the right to plagiarise the source.

7.2 Trinity Policy on Plagiarism

Plagiarism is interpreted by the University as the act of presenting the work of others as one's own work, without acknowledgement. Plagiarism is considered as academically fraudulent, and an offence against University discipline. The University considers plagiarism to be a major offence, and subject to the disciplinary procedures of the University. Plagiarism can arise from deliberate actions and also through careless thinking and/or methodology. The offence lies not in the attitude or intention of the perpetrator, but in the action and in its consequences.

Plagiarism can arise from actions such as:

- (A) Copying another student's work
- (B) Enlisting another person or persons to complete an assignment on the student's behalf
- (C) Quoting directly, without acknowledgement, from books, articles or other sources, either in printed, recorded or electronic format
- (D) Paraphrasing, without acknowledgement, the writings of other authors

Examples C) and D) in particular can arise through careless thinking and/or methodology where students:

1. Fail to distinguish between their own ideas and those of others
2. Fail to take proper notes during preliminary research and therefore lose track of the sources from which the notes were drawn
3. Fail to distinguish between information which needs no acknowledgement because it is firmly in the public domain, and information which might be widely known, but which nevertheless requires some sort of acknowledgement
4. Come across a distinctive methodology or idea and fail to record its source.

All the above serve only as examples and are not exhaustive.

Students should submit work done in co-operation with other students only when it is done with the full knowledge and permission of the lecturer concerned. Without this, work submitted which is the product of collusion with other students may be considered to be plagiarism. When work is submitted as the result of a Group Project, it is the responsibility of all students in the Group to ensure, in so far as possible, that no work submitted by the Group is plagiarised.

It is clearly understood that all members of the academic community use and build on the work of others. It is commonly accepted also, however, that we build on the work of others in an open and explicit manner, and with due acknowledgement. Many cases of plagiarism that arise could be avoided by following some simple guidelines:

- (A) Any material used in a piece of work, of any form, that is not the original thought of the author should be fully referenced in the work and attributed to its source. The material should either be quoted directly or paraphrased. Either way, an explicit citation of the work referred to should be provided, in the text, in a footnote, or both. Not to do so is to commit plagiarism
- (B) When taking notes from any source it is very important to record the precise words or ideas that are being used and their precise sources
- (C) While the internet often offers a wider range of possibilities for researching particular themes, it also requires particular attention to be paid to the distinction between one's own work and the work of others. Particular care should be taken to keep track of the source of the electronic information obtained from the Internet or other electronic sources and ensure that it is explicitly and correctly acknowledged.

It is the responsibility of the author of any work to ensure that they do not commit plagiarism. Students should ensure the integrity of their work by seeking advice from their Lecturers, Course Co-ordinator, Director or Supervisor on avoiding plagiarism. All Schools should include, in their handbooks or other literature given to students, advice on the appropriate methodology for the kind of work that students will be expected to undertake.

If plagiarism as referred to in paragraph (2) above is suspected, the Director of Teaching and Learning (Postgraduate) will arrange an informal meeting with the student, the student's Supervisor or other appropriate representative, and the academic staff member concerned, to put their suspicions to the student and give the student the opportunity to respond.

If the Director of Teaching and Learning (Postgraduate) forms the view that plagiarism has taken place, they must decide if the offence can be dealt with under the summary procedure set out below. In order for this summary procedure to be followed, all parties noted above must be in agreement. If the facts of the case are in dispute, or if the Director of Teaching and Learning (Postgraduate) feels that the penalties provided for under the summary procedure below are inappropriate given the circumstances of the case, they will refer the case directly to the Junior Dean, who will interview the student and may implement the procedures set out in Section 5 (Other General Regulations).

If the offence can be dealt with under the summary procedure, the Director of Teaching and Learning (Postgraduate) will recommend to the Dean of Graduate Studies one of the following penalties:

- (A) That the piece of work in question receives a reduced mark, or a mark of zero;
or
- (B) If satisfactory completion of the piece of work is deemed essential for the student to rise with his/her year or to proceed to the award of a degree, the student may be

required to re-submit the work. However, the student may not receive more than the minimum pass mark applicable to the piece of work on satisfactory re-submission.

(C) Provided that the appropriate procedure has been followed and all parties above are in agreement with the proposed penalty, the Dean of Graduate Studies may approve the penalty and notify the Junior Dean accordingly. The Junior Dean may nevertheless implement the procedures set out in Section 5 (Other General Regulations).

All students must read the section in the University Calendar pertaining to plagiarism which is to be found here: <http://www.tcd.ie/calendar/>

All students must complete the online tutorial on avoiding plagiarism 'Ready, Steady, Write', located at <https://libguides.tcd.ie/academic-integrity/ready-steady-write> before submitting any written material for assessment.

The weblink to the Library Repository on plagiarism can be found here: <https://libguides.tcd.ie/academic-integrity>

8 HOW TO SUBMIT WRITTEN WORK

Students are required to submit their assigned essays, projects, and other assessed work by 12 noon on the appointed date. The work should be submitted online via www.turnitin.com accompanied by an Essay Cover Sheet, an example of which is included in Appendix 12.3 below. These cover sheets will be emailed to each student in advance of the first assignment due. Until receipt of the essay has been confirmed by the Administration Office, submission requirements will not be considered as having been met.

Work that cannot be submitted online e.g. portfolios, large logbooks, etc. must be hand delivered to the Administration Office during posted office hours, prior to the deadline. A log will be maintained of work submitted.

Students are advised that they are required to keep a copy of all work submitted. The Lir Academy will exercise extreme care in collecting and receipting assessment materials, but if any materials go astray, it will be the student's responsibility to provide a copy replacing it.

When submitting written work, students must include the following statements on their submission sheet:

I have read and I understand the plagiarism provisions in the General Regulations of the University Calendar for the current year, found at <http://www.tcd.ie/calendar>

I have also completed the online tutorial on avoiding plagiarism 'Ready, Steady, Write', located at <https://libguides.tcd.ie/academic-integrity/ready-steady-write>

9 IMPORTANT SAFETY ISSUES FOR STUDENTS

9.1 Security

Students should ensure that all valuables are always kept with them - this includes notebooks, logbooks and written assignments, as these are often irreplaceable. Please note that lockers are not immune from theft. Students should take care to close and lock any windows or doors after they have finished using a space. This is particularly important with regards to the back and front entrances to the building.

Bicycles are equally vulnerable and should be securely locked to the stands provided by The Lir Academy. No bicycles are allowed inside the building, nor may they be chained to the railings at the entrance to The Lir Academy. Any unauthorised bicycles found illegally parked will be clamped and a €10 fee will be incurred for their release.

For security reasons, The Lir Academy will be locked by security from 10pm each evening. Students must have vacated the building by this time so as not to set off the alarm. There is no access for students after that time, unless accompanied by a member of staff. At weekends, The Lir Academy will be accessible from 10am-6pm only to rehearse or prepare for class. When a public performance is taking place in the theatre, only students directly involved with the production are allowed in the Academy after 10pm. Strangers are permitted in the building as far as the administrative office only. Any stranger found in the building should be directed to the administrative office or to a member of staff.

9.2 Fire Safety Procedures

Students must sign in every day before class at the sign-in station in the foyer. Students must also sign themselves out of the building upon leaving at the end of the day.

In the event of an emergency, students must

- Follow the directions of The Lir's staff
- Vacate the building in an orderly manner
- Go directly to the designated Assembly Point
- Not to return to the building until it is deemed safe to do so by the Fire Brigade or the appointed Lir Fire Officer

Please note that

- Emergency Exits must be kept clear at all times
- Items placed in Emergency Exits must be reported directly to the Administrator between the hours of 9am-5pm and to the Front of House Manager thereafter
- Students will undertake an annual fire evacuation drill in the first weeks each new year

9.3 Working with Equipment

All technical work in The Lir's Studios and Workshop must be supervised and/or authorised by a member of staff, and safety guidelines must be observed at all times when working with technical equipment.

9.4 Health and Safety

- The Lir Academy operates a detailed Health & Safety Policy to which students are required to adhere
- First Aid equipment and staff trained as occupational first aiders shall be provided by The Lir
- First Aid Kits are available from the Administration Office on the first floor and at the cafe area on the ground floor

9.5 Housekeeping

It is important that students leave spaces clean and tidy for the next class or rehearsal. Chairs should be stacked at the end of each class and placed against the wall, unless otherwise arranged by the teacher. Please ensure that all rubbish is placed in the rubbish-bins provided.

This is particularly important in both the café/foyer and Studios as these are the public areas of The Lir Academy and should be ready for visitors at all times.

10 DATA PROTECTION

The Lir Academy, in association with Trinity College Dublin, is required to process relevant personal data regarding students and staff as part of its operation. It endeavours to ensure that this is done in compliance with all relevant Data Protection legislation. Therefore, you will be required to sign a 'Permission to Disclose Information' form, which can be found at the back of this handbook. All signed forms should be handed in to the administration office.

11 CODES OF PRACTICE

The Lir's Codes of Practice are aimed at encouraging and developing a shared sense of responsibility in students – this includes a responsibility for oneself, one's fellow students, and the work environment.

11.1 Punctuality and Attendance

Students are required to be present and on time for all classes and call times. They should aim to arrive well in advance of the commencement of class and call times and should arrive no later than five minutes before the official starting time.

11.2 Illness or Other Absence

Students are expected to attend all timetabled classes and workshops. Students are asked to inform the Administrator via reception on (01) 896 2559 if they are unable to attend classes or rehearsals due to illness or any other reason.

11.3 Student Housekeeping

Students have an express obligation toward the upkeep and maintenance of all Lir spaces, including rehearsal rooms, classrooms, theatres, dressing rooms and communal areas.

11.4 General Upkeep of Rehearsal Rooms, Studios and all Classrooms

The main classroom spaces of The Lir Academy are: Rehearsal Rooms 1-5; Studio 1 and Studio 2 (outside of production times); the Dance Studio; and Seminar Room. These rooms are in constant use by a large number of different groups each day and students must assist in keeping these rooms in good order to ensure the smooth running of the building.

At the end of each and every class, students should note that:

- All chairs are to be stacked against one wall and move any tables or other furniture to one side, leaving the space clear, clean and in a good state of readiness for the next group of room users.
- All rubbish should be placed in bins and all personal items and paperwork removed from the room. Anything inadvertently left behind should be placed in lost property containers. See note on lost property below.

- Class tutors should leave time at the end of classes to allow for this tidy up, and class-reps and vice-reps should ensure it is being carried out by their year groups on an ongoing basis.
- Each classroom space should have 20 stacking chairs, a table and waste bins provided. Rolling whiteboards are also provided in Rehearsal Room 1, Studio 2 and Rehearsal Room 3, whilst the Dance Studio should contain only dance mats, and no furniture.
- In order to maintain the default room set up, please avoid moving classroom furniture about the building. Any furniture that is moved as part of a class must be replaced immediately afterwards.
- Nothing may be stored in classrooms or studios without advance permission from venue or technical staff. In particular props, furniture or costumes that may be in use for classes must be returned to storage on a daily basis.
- Additionally, furniture or bins must not be removed from classrooms and left in the corridors outside. Neither may shoes, bags or clothing be left in corridors outside classes.

All corridors in the building are fire escape routes and must be kept completely clear at all times.

11.5 Personal Property and Storage

MFA design students have a dedicated studio for their classes. This room should be locked at the end of each day and the key stored in the staff room

The design studio must be kept clean and tidy - please be mindful that this is a shared space.

- Your personal property (including clothing, footwear, bags and paperwork) must not be left lying around the Academy, either in classrooms, shared spaces or in the corridors.
- Student locker areas and the student cloakroom are available for storage of your personal belongings. Please do not allow your property to accumulate in the Academy throughout the term – bring in only what you need for classes and take your belongings home on a regular basis.
- Storage areas are very busy and have limited space, and they must be kept in good order.
- For reasons of fire safety, absolutely nothing may be placed on top of lockers and nothing is to be left on the floor of the cloakroom or locker areas
- Items left on the floor or on top of lockers are liable to be disposed of at any time.
- Coats, bags, towels and other items should be hung up on coat hooks
- Shoes, extra clothing and any valuable personal belongings should be kept in your locker
- Yoga mats must be stored on the top shelves in the cloakroom only
- Please avoid keeping perishable foodstuffs in the design studio, your locker or on the cloakroom shelves – these belong only in the Green Room
- You will receive a notification in advance asking you to empty your locker and clear your personal belongings from the student storage areas on the last day of each term
- The Academy is used for many events and short courses outside of term time and so it is essential that storage areas are cleared in a timely fashion at each term end
- All items left behind in these areas after end of term will be immediately disposed of or donated to charity

11.6 Lost Property

- Any clothing or personal items left behind in classrooms or studios during term time should be placed into the lost property containers, which are provided in Rehearsal Rooms 1-6, Dance Studio, Resource Room and Green Room.
- Valuable items, i.e. jewellery, phones, wallets etc. should be dropped to the Administration office.
- Academic paperwork, books and journals (which may be of very high personal value to an individual student), should ideally be dropped to the lost property box on the shelves of the Resource Room which is designated for this purpose.
- Lost property containers will be emptied up to twice per term, and the contents disposed of or donated to charity.

11.7 Food and Drink

- All food and hot drinks may be consumed in the Green Room or the Café area in the Front Foyer only
- With the exception of bottled water, students are not allowed to eat or drink in any of The Lir's classrooms, studios, rehearsal rooms or workspaces
- This includes but is not limited to: Rehearsal Rooms 1-6; Studio 1 and Studio 2; Dance Studio; Seminar Room; Resource Room; Dressing Rooms; Wardrobe; Construction and Scenic Workshops
- Bottles of water may be brought into classes and workspaces
- Water fountains are located outside Rehearsal Room 1 and Studio 2
- The chewing of gum is not permitted in any class

11.8 Green Room and Café/Front Foyer

Students may use the cafe area situated in the front foyer of The Lir or the Green Room for meal breaks. Students using these areas to eat and drink must clear up after themselves immediately after use. As both areas are used by a large number of people each day it is essential that students take responsibility for keeping them in good order.

Use of the Café/Front Foyer:

The cafe area in the front foyer is a public-facing area and must be kept presentable at all times.

- All rubbish must be placed in the bins provided
- Personal items such as cups and bowls must not be left in the cafe area
- Kitchen facilities are provided in the Green Room to wash crockery items after use
- Each student must take responsibility for their own items and any crockery/Tupperware left in the front foyer will be disposed of
- Please re-set foyer tables and chairs, clean up any spillages or food waste, and leave the area in good order after use
- Furniture should not be removed from the front foyer without permission from a member of venue or technical staff

Use of the Green Room:

The Green Room has seating areas where students may take their meals and has kitchen facilities available for student use.

- All rubbish generated must be placed in the bins provided.

- Any crockery or cutlery must be washed up immediately after use and tables and countertops should be left clean, free from debris and wiped down as necessary.
- Personal belongings and clothing must be hung up on coat racks, and not left lying around on the couches, tables or floors.
- Green room cleaning supplies are provided by The Lir Academy and are stored in the kitchen area.
- Lunch boxes may be stored in the refrigerator provided.
- Due to limited space the refrigerator is for day-use only and should not be used for long term storage of food.
- All fresh food items in the refrigerator should be in covered containers, or sealed packaging.
- Microwaves are provided for student use. These must be kept clean and in a fit condition for the next student to use.
- Any spillages in microwaves should be cleaned up immediately.
- Dry food stuffs may be stored on the shelving unit above the sink only, and not in the presses below, where they pose a risk of attracting vermin.
- Please use the presses only for storage of crockery and Tupperware
- In order to save food storage space, please keep these items off the shelves.
- In the interest of health and safety all personal food items must be cleared out of the student refrigerator at the end of each week and from the kitchen shelves at the end of each term.
- Green Room furniture should not be moved about or removed from the green room without permission from a member of venue or technical staff.

11.9 Resource Room

The Resource Room is located on the first floor and is for use by all students, acting as the student computer room and library space for the building.

It is a **quiet work space** where talking and other noise should be kept to minimum. Please respect your fellow students when working in the Resource Room and avoid causing a distraction. Computer use should be prioritised for academic work only. Please log out of computers when you are finished using them.

No food or drink is to be brought into the Resource Room, with the exception of bottled water.

The shelves in the Resource Room are for storage of library books and academic paperwork only. Absolutely no personal belongings such as food, clothing, bags, yoga mats etc. may be stored loose on the shelves of the Resource Room or left on the windowsill or radiators. Any personal items left loose on the Resource Room shelves, windowsill or radiators are liable to be disposed of at any time.

11.10 Wardrobe and Costume Guidelines

MFA students requiring costumes for classes or projects are asked to contact the Head of Costume and Wardrobe Supervisor Clodagh Deegan (clodagh.deegan@thelir.ie) at the beginning of each project or at the soonest available opportunity.

Important Costume Guidelines:

- Please note that final year productions take precedence on any and all costumes.

- If costumes are soiled from use this must be brought to the costume supervisor's attention and left in the laundry.
- All dressing rooms, rehearsal rooms and studios are to be cleared of costumes after use.
- Any costumes or other items of clothing returned with costumes will be absorbed into the costume stock.
- All costumes must be treated with respect and care particularly when being stored.

11.11 Props Store Guidelines

MFA students requiring props for classes or projects are asked to contact the Head of Stage Management, Aisling Mooney (aisling.mooney@thelir.ie) at the beginning of each project or at the soonest available opportunity.

Further Important Prop Guidelines:

- Please note that final year productions take precedence on any and all props.
- No sharp implements are allowed to be used as rehearsal props at any time.
- Use of flame or any potentially hazardous materials must be cleared in advance through a member of technical staff.
- Props brought in by staff or students not from the props store must be removed after every class and stored in an appropriate place.
- No external borrows for outside student shows.

11.12 Professional Courtesy

Both staff and students are responsible for the creation of a positive working atmosphere. It is important therefore that professional courtesy is maintained at all times in all classes and rehearsals.

11.13 Scripts and Photocopying

The Lir Academy has one multi-function device located in the Student Resource Room, on the first floor. The printing, scanning and photocopying facilities in The Lir Student Resource Room, Trinity Libraries and Trinity computer rooms are managed by IS Services and the College Library, and provided by Datapac. There are also multi-function devices (MFDs) in the College Libraries and College computer rooms located throughout the campus, and in some off campus locations.

Note that in order to be able to use this service you must first credit your print account. Please log on to the link below for details on how to set up and credit your print account:

<https://www.tcd.ie/Library/using-library/photocopying.php>

The Lir Academy aims to limit the use of paper in the Academy where possible, we ask students to only print out materials when it is absolutely necessary to do so. A scanner will also be provided for ease of sharing material between students by email.

Students are expected to familiarise themselves with all relevant copyright legislation and not to infringe the copyright of any author when photocopying material.

11.14 Mobile Phones/Social Networking/Recording Devices

We ask students to turn off all mobile phones before coming into class or rehearsals. No phone calls can be made during these periods. Phones should be turned on only when outside the studio or classroom. Individual tutors will communicate a policy on the use of kindles tablets or laptops in their classes. Students are asked not to photograph, record or video any classes or performances at The Lir, and not to share any such recordings online on any forum.

11.15 Food and Drink

With the exception of water and other drinks, students are asked not to eat or drink in any of the spaces they work in.

11.16 Cloakrooms and Lockers

- Lockers and cloakroom facilities are provided to each student for the storage of their items needed for their day-to-day activities.
- Students are asked not to store personal clothing items for long periods of time.
- Locker areas and cloakroom facilities **MUST** be kept clear at all times as a matter of our Fire Evacuation Policy.
- Locker and cloakroom areas will be spot-checked twice a week, mid-week and every Friday.
- Should items be left lying around they will be discarded.

11.17 Press and Publicity

Any publicity relating to your attendance at The Lir Academy will be at the discretion of the Director of The Lir Academy.

11.18 No Smoking Policy

In keeping with Irish legislation regarding smoking in the workplace it is illegal to smoke anywhere in The Lir Academy.

The smoking areas for the students are situated at the back of The Lir Academy, beside the entrance to The Tower and outside the construction workshop. Students must exit from the main entrance and walk around to the smoking areas. In the interest of safety and security, it is not permissible to use fire escapes to access these areas.

11.19 Alcohol or Drug Abuse

Students are not allowed to drink alcohol anywhere in The Lir Academy (except at authorised receptions or other public functions), or use drugs, and no student will be allowed into class or rehearsal while under the influence of alcohol or drugs (unless prescribed by a doctor). Any student drinking alcohol or using drugs on the premises will be liable to immediate disciplinary action.

11.20 Dignity & Respect

At The Lir Academy, we are committed to providing a safe and respectful work environment for all - whether an employee, a student, a contractor, a supplier, or a member of the public. No one has the right to harass or bully anyone else, at work or in any situation related to employment. The Lir Academy has a comprehensive Bullying and Harassment policy in place,

which is available in the Policies section of The Lir's website (www.thelir.ie/policies). This policy outlines the steps that students can take if they are subject to harassment or bullying of any kind while studying at The Lir Academy. The Lir's Bullying and Harassment Policy works within the parameters of Trinity's over-arching Dignity & Respect Policy which can be found online [here](#).

11.21 Disruptive or Violent Behaviour

Students who offend or harm a member of staff or another student by means of violent acts (including verbal abuse such as swearing, shouting or screaming), or personal harassment (or behaviour likely to produce this effect), will be liable to immediate disciplinary action and dismissal from the course.

11.22 Sexual, Gender or Racial Harassment

Students should note that any kind of sexual, gender or racial harassment is unacceptable behaviour. In addition, all students have the right to determine their own gender identity and sexual orientation, free from any kind of prejudice or pressure. Any student who engages in sexual or racial harassment will be liable to immediate disciplinary action. In an intensive actor-training course, students are often called upon to take risks, which can take someone to limits of emotional or physical comfort. It is important for the student to know their boundaries - the place beyond which they will be compromised. It is the responsibility of fellow students and tutors to respect these limits; no student will ever be penalised for refusal to undertake an activity which they feel is dangerous - ethically, psychologically, or physically. The studio framework and exploratory nature of our classes should never be presumed to license behaviour which would otherwise be considered socially unacceptable.

11.23 Gender Equality

In 2018, in partnership with other leading theatre organisations The Lir Academy published a detailed Gender Equality Policy which articulates the Academy's commitment to achieving Gender Equality across a whole range of the academy's activities from staff and student recruitment to production choices and the composition of creative teams, sexual harassment and bullying protocols, and the content of individual curricula. The document also outlines the strategies that The Lir Academy will implement in order to ensure improvements are implemented where necessary. Students can access the Gender Equality Policy from the Policies and Procedures section of The Lir's website at www.thelir.ie/policies.

11.24 Maintaining Good Health

Students are encouraged to remain conscious of their physical and mental wellbeing throughout the year and to seek assistance from Lir teachers and staff if they are encountering any particular problems.

- Students should also avail of Trinity's medical and counselling services as often as they are needed.
- Students are encouraged to eat healthily throughout the year, drink plenty of water during the college day and get sufficient sleep at night.
- Students who have an underlying health issue or develop a health problem during their course are encouraged to bring it to the attention of the Administrator as soon as possible. Personal information regarding health issues will only be shared with relevant

teachers with the express permission of the student on completion of The Lir's Permission to Disclose Health Information form; an example of which is included in Appendix Two below.

- Students who are asked to complete the form will meet with the Director of The Lir Academy in confidence to discuss the implications of each option and the best course of action for the student.

11.25 Sustainability and Student Responsibility

The Lir Academy is striving to become a Green Campus. To meet this target, students are expected to familiarise themselves with the Sustainability Policy and to take responsibility for their own waste while The Lir Academy works to cut their waste and carbon footprint.

Single Use Plastic:

The use of single use plastic at The Lir Academy is discouraged. We ask that students consider their choices when buying lunches and opt for compostable containers instead of plastic. Composting facilities are available in the Green Room and The Foyer. Water fountains are available throughout the building to refill reusable water bottles.

Coffee cups:

Many single use coffee cups are NOT recyclable or compostable and we recommend the use of a Keep Cup. All local cafes offer discounts for the use of reusable coffee cups.

Theatre Productions:

The Lir Academy is adapting to the climate crisis by adopting a model of sustainable theatre making as outlined in The Theatre Green Book (www.theatregreenbook.com). Students are asked to familiarise themselves with new sustainable working practices as outlined by staff and work under their guidance as working practices change to make The Lir Academy and theatre production more sustainable.

12 APPENDICES

1 Permission to disclose personal information form

STUDENT PERMISSION TO DISCLOSE PERSONAL INFORMATION FORM

Name of Student:

.....

Course Title:

.....

Course start date: (MM/YY) Course completion date..... (MM/YY)

The Lir Academy acknowledges student's rights under data protection legislation and takes seriously its obligations to keep all personal information confidential. It may be necessary, however, to publish a student's name, image, likeness, agreed biography, images of their course or production work in The Lir's publications, or in other formats or media at the discretion of the Director, for the following reasons:

- To fulfil the objectives of the Master in Fine Art
- To promote The Lir's students to industry

- To support students' future careers
- To promote The Lir Academy
- To promote the courses offered by The Lir Academy

I hereby agree to allow The Lir Academy to use my name, image, likeness, agreed biography, images or video recordings of my work in workshops or Gradfest productions for the purposes outlined above.

Student signature..... Date

Please note that this form complies fully with Data Protection legislation

2 Permission to disclose health information form

STUDENT PERMISSION TO DISCLOSE HEALTH INFORMATION FORM

This form is Part 1 of the Learning Agreement Form. Depending on your response, it will be either be:

Circulated to the appropriate members of staff at the discretion of the Director OR Retained in the student confidential file.

Name of Student:

.....

Course Title:

.....

..... Course start date: (MM/YY) Course completion date (MM/YY)

Condition / disability:

.....

Nature of documentary evidence if appropriate - e.g. report from educational psychologist, medical report etc. (please attach)

.....

Please complete one of the sections below:

A. I give my permission for appropriate members of The Lir's staff to be made aware of my disability/condition so that appropriate help and support can be provided.

Student signature Date.....

B. I do not give my permission for staff of The Lir Academy to be made aware of my disability/condition and I understand that the full appropriate support may not be available to me.

Student signature..... Date

C. I agree to discuss my disability fully with the Director but will take responsibility for discussing the nature of my disability/ condition direct with teaching staff, so that appropriate help and support can be provided, if necessary

Student signature..... Date

Please note that this form complies fully with Data Protection legislation

3 Written Work Submission Form

ESSAY COVER SHEET

The Lir, National Academy of Dramatic Art	
Essay/Logbook Cover Sheet	
Please fill out with block capitals/tick the appropriate boxes and attach to the front of your essay/logbook	
Name:	
Student Number:	
Email Address:	
<i>Please tick the course in which you are enrolled:</i> Foundation Diploma in Acting and Theatre Studies Bachelor in Stage Management and Technical Theatre Master in Fine Art For undergraduate courses please tick: Year 1 Year 2 Year 3 For the MFA course, please tick your specialism: Playwriting Directing Design Producing	
Essay Title:	
Course Tutor:	
Course Title:	
<i>Please tick which term this essay is for:</i> Term 1 Term 2 Term 3 I also confirm that have read and I understand the plagiarism provisions in the General Regulations of the University Calendar for the current year, found at: http://www.tcd.ie/calendar I have also completed the Online Tutorial on avoiding plagiarism 'Ready, Steady, Write', located at http://tcd-ie.libguides.com/plagiarism/ready-steady-write Date of submission: Signature:	
Please Note: Essays must also be submitted electronically by the due date through www.turnitin.com	

Building Maps

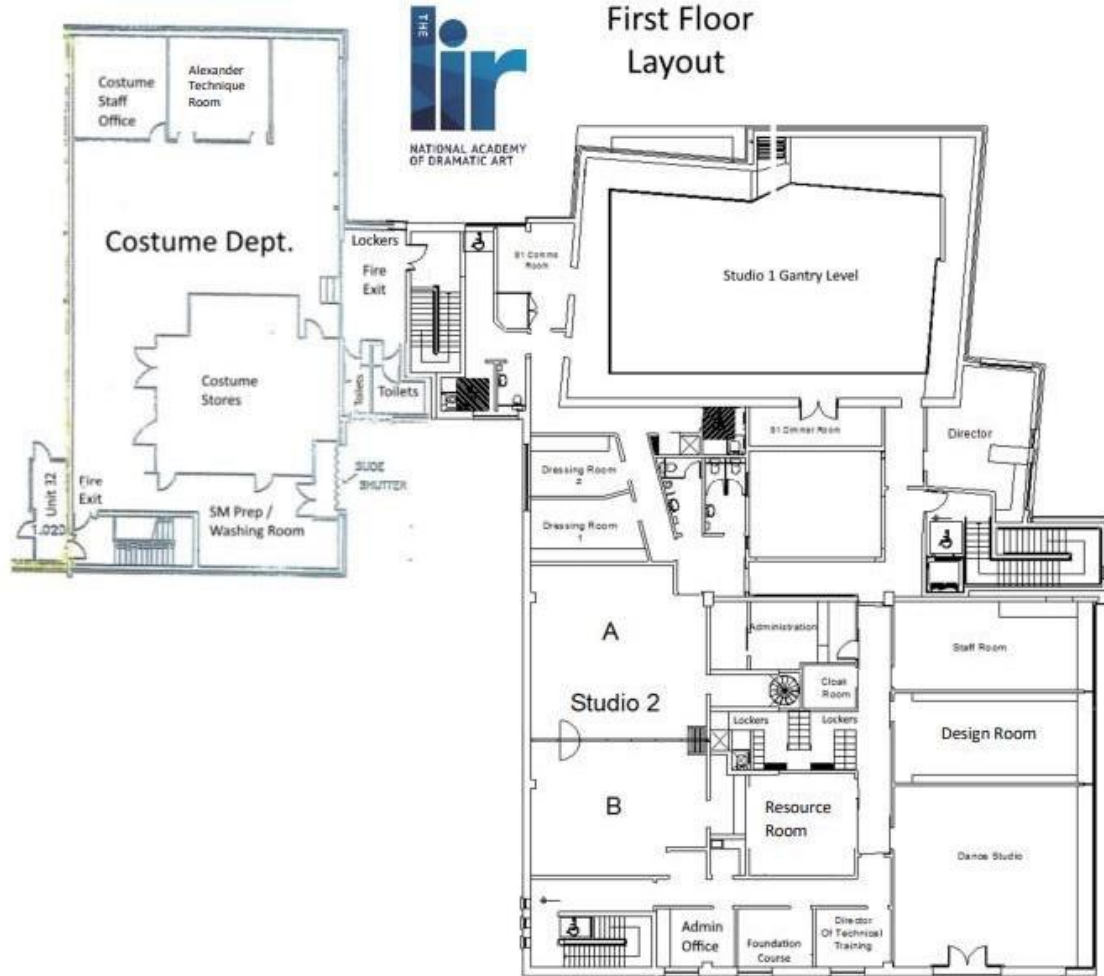



THE NATIONAL ACADEMY OF DRAMATIC ART

Ground Floor Layouts

Unit 33-35

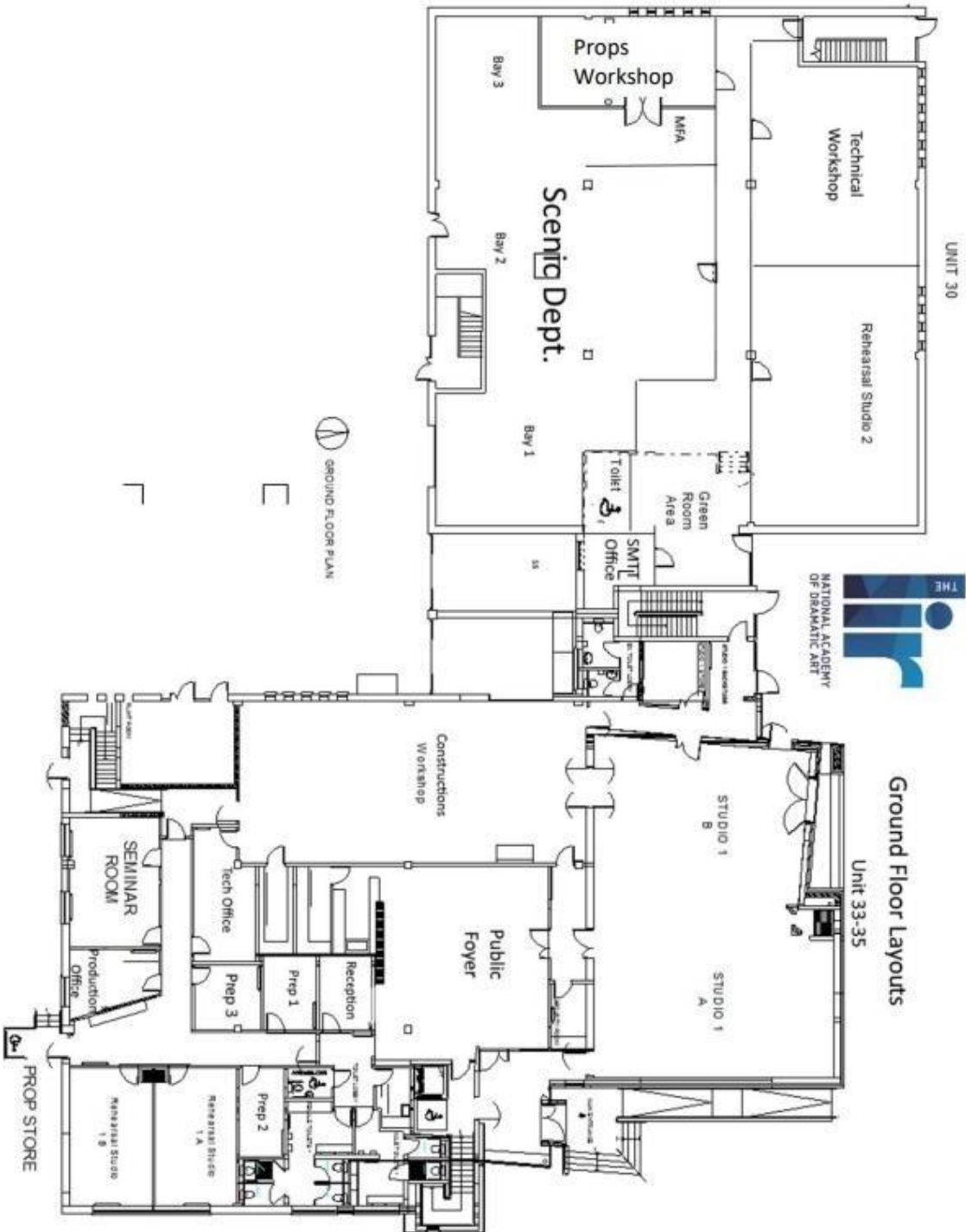

GROUND FLOOR PLAN

ATRL Ground Floor Unit 13/14

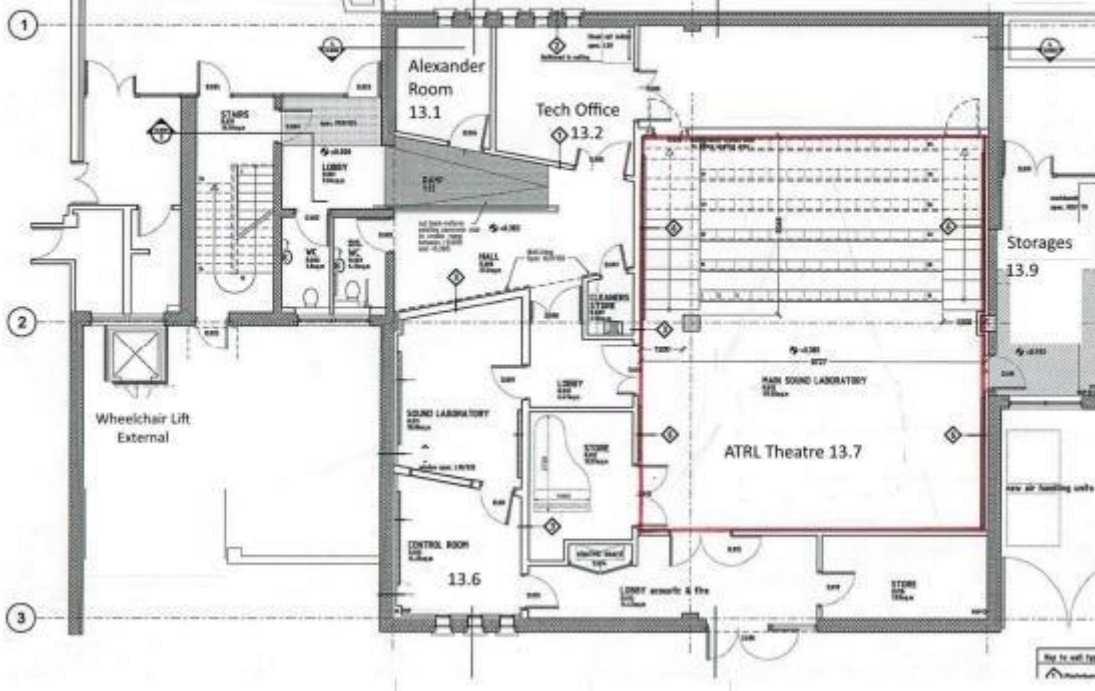

ATRL Unit 13 /14 First Floor



Unit 31

